



WILLARD
INTERCONTINENTAL[®]
WASHINGTON D.C.



or 150 years, the Willard InterContinental has been an integral part of Washington society. Our turn-of-the-century Crystal Room is the preferred site for glittering galas, receptions and noteworthy events. The Ballroom, with its magnificent crystal chandeliers, high ceiling and murals, is another grand setting for meetings and social events. A large pre-function area, connected to the Ballroom, provides for guest registration, pre-dinner drinks and mingling during intermissions.

ACCOLADES

- AAA Four Diamond Award
- *Travel + Leisure* 500 World's Best Hotels 2008
- *International Hotel & Restaurant Association* 2007 Sustainable Development Award
- *National Geographic* Traveler Stay List, Top 150 Hotels 2008



CONFERENCE FACILITIES

	L & W	Square Feet	Ceiling Height	Theatre Seating	Classroom Seating*	Reception	Banquet Seating	Conference Seating	Hollow Rectangle Seating
LOBBY LEVEL									
Crystal Room	64 x 40	2,560	15'	250	120	250	210	45	60
Peacock Lounge	34 x 30	1,020	15'	250	120	250	210	45	60
SECOND FLOOR									
Brandeis	32 x 16	512	8.5'	50	30	60	30	20	20
Chase	26 x 16	416	8.5'	40	24	50	30	20	20
Douglas	30 x 26	780	8.5'	80	40	75	60	28	30
Holmes	29 x 20	580	8.5'	60	30	75	50	20	24
Hughes	32 x 32	768	8.5'	70	30	75	60	24	26
Stone	25 x 16	400	8.5'	40	24	50	30	20	20
Taft	30 x 26	780	8.5'	80	40	75	60	28	30
Grant Suite	17 x 30	510	8.3'	28	18	60	24	20	14
MEZZANINE LEVEL									
The Nest	36 x 25	900	8'	80	45	110	90	30	34
LOWER LEVEL									
Ballroom	74 x 64	4,736	9'4" & 18'	450	250	600	450	50	80
Buchanan	34 x 34	1,156	9'	90	60	150	100	28	30
Fillmore	31 x 15	465	9'	40	30	70	30	20	20
Garfield	26 x 16	416	9'	40	25	50	30	20	20
Pierce	64 x 31	1,984	9'	220	100	250	200	45	60
Taylor	30 x 20	600	9'	50	40	75	40	24	24
Ballroom Foyer	30 x 20	2,176	9'	-	-	150	-	-	-

*Setups are 3 people per 6' table. Audio/visual equipment may affect capacity. Full facility accessibility in compliance with the American with Disabilities Act.

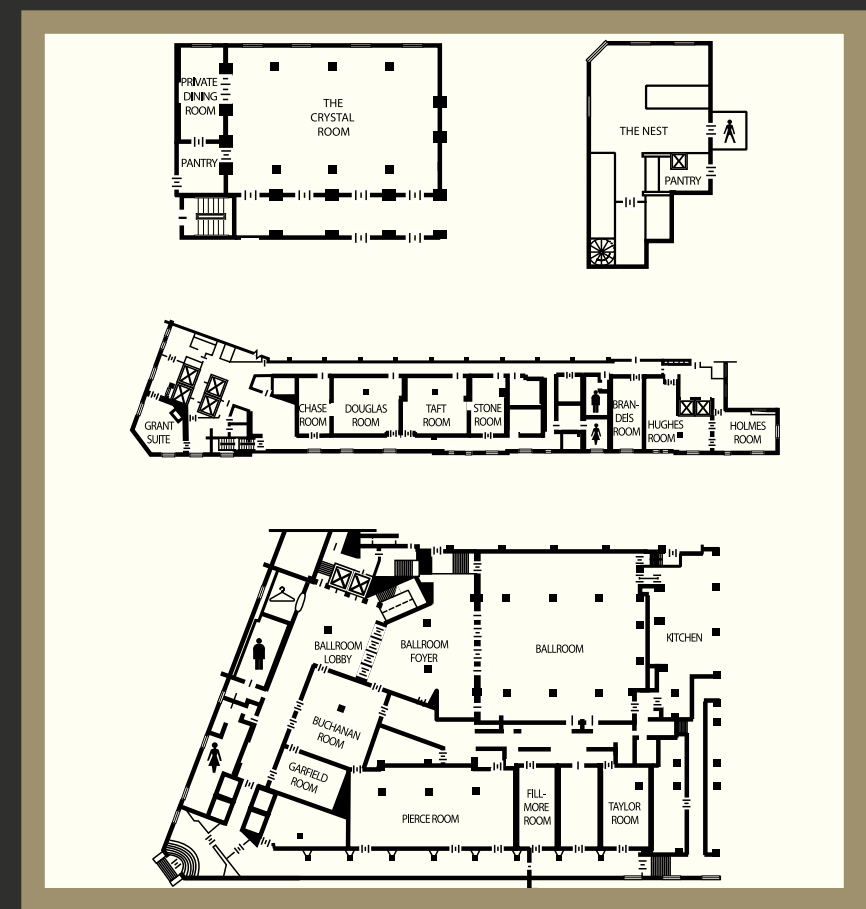



ATTRACTIONS

Located within walking distance of the National Mall, Smithsonian Museums, Verizon Center and Washington Convention Center. Enjoy a short ride to Capitol Hill, Union Station and Reagan National Airport.

AIRPORTS

Reagan National (DCA): 7 miles/15 minutes

Dulles International (IAD): 35 miles/45 minutes

Baltimore Washington International (BWI): 40 miles/50 minutes

THE WILLARD INTERCONTINENTAL HOTEL

1401 Pennsylvania Avenue NW

Washington, DC 20004-1010

p 202.628.9100

f 202.637.7326

www.washington.intercontinental.com