



**DOUBLE TREE®  
HOTEL**

**DOWNTOWN WILMINGTON - LEGAL DISTRICT**

700 N. King Street

Wilmington, DE 19801



Can you really be  
*this* efficient?

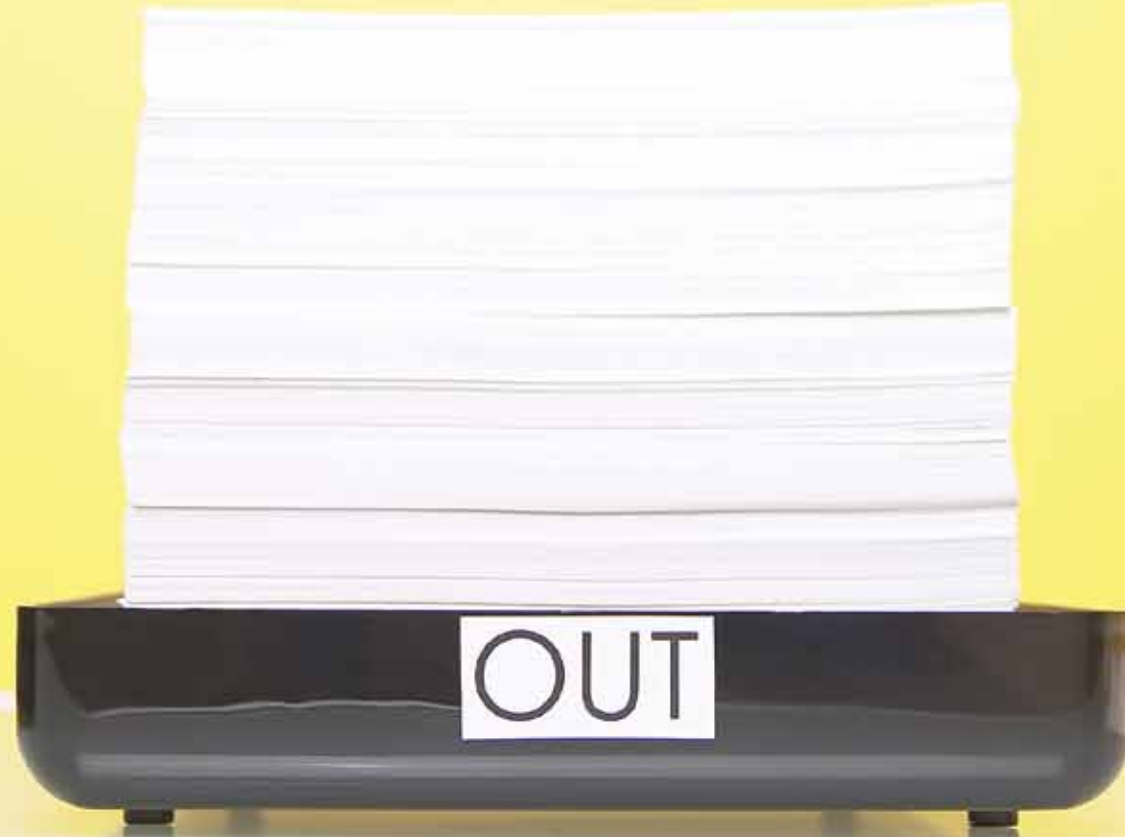

*Most definitely.*



Out-of-town firms preparing for trial in Wilmington, Delaware have great things to say about the DoubleTree Legal Center. Those who utilize the Legal Center have private access to spacious offices and board rooms, a fully functional administrative center and an ideal location just blocks from the Downtown Wilmington Legal District. Read on to learn how the DoubleTree Downtown Wilmington can streamline your experience.



## CONVENIENT

Boasting a central location and countless amenities, the DoubleTree Downtown Wilmington Legal Center is the ideal place for out-of-town firms to set up shop while practicing in Delaware. Here are just a few of the amenities your legal team will enjoy while working and staying with us:

- Two private lead counsel offices
- Large conference room that seats 12
- Seven paralegal workstations
- Large storage/work room with ample shelving
- 16 phone lines and three fax lines
- On-site audio-visual services
- On-site catering and a full-service restaurant/lounge
- Two private secured entrances
- Kitchen with full-size refrigerator and microwave
- More than 20,000 square feet of meeting space
- Convenient lodging in 217 guest rooms and well-appointed executive suites
- Guaranteed Internet connectivity





## EXPERT SERVICE

Guests of the DoubleTree Downtown Wilmington Legal Center can be assured that their stay will be a flawless one. Our attentive staff works closely with guests to ensure all needs are met quickly and completely.

For reservations or information, contact our legal market representative at (302) 655-0400 or [ILGDT\\_DS@hilton.com](mailto:ILGDT_DS@hilton.com).

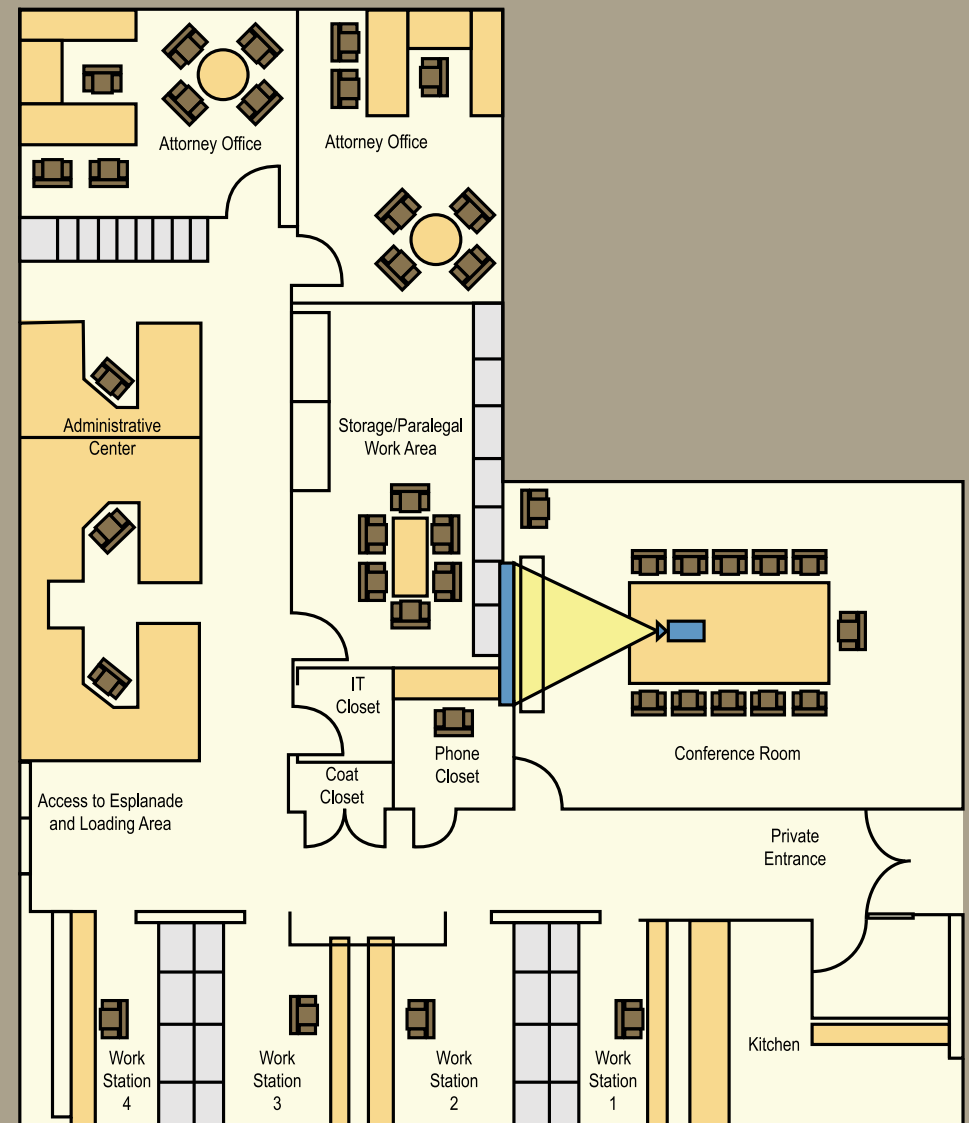

## EFFICIENT

To make your stay with us even more productive, the DoubleTree Downtown Wilmington Legal Center has partnered with Parcels®, TriState Courier and Reliable®, three regional litigation support providers, to address the document production and management needs of our guests, including:

- On-site copier with or without office support staffing
- Off-site copying, scanning, trial exhibits, blowback and binder creation
- Mailing, overnight, messenger and hand-delivery services
- Database design and management
- Electronic discovery services
- Trial presentations, including preparation of electronic exhibits and oversized documents



DOWNTOWN WILMINGTON - LEGAL DISTRICT

700 N. King Street, Wilmington, DE 19801  
 Phone (302) 655-0400 Fax (302) 429-5979  
[www.wilmingtonlegalcenter.com](http://www.wilmingtonlegalcenter.com)